

Willow Grove, Pennsylvania 1130 Easton Road

WILLOW GROVE, PA 1130 Easton Road

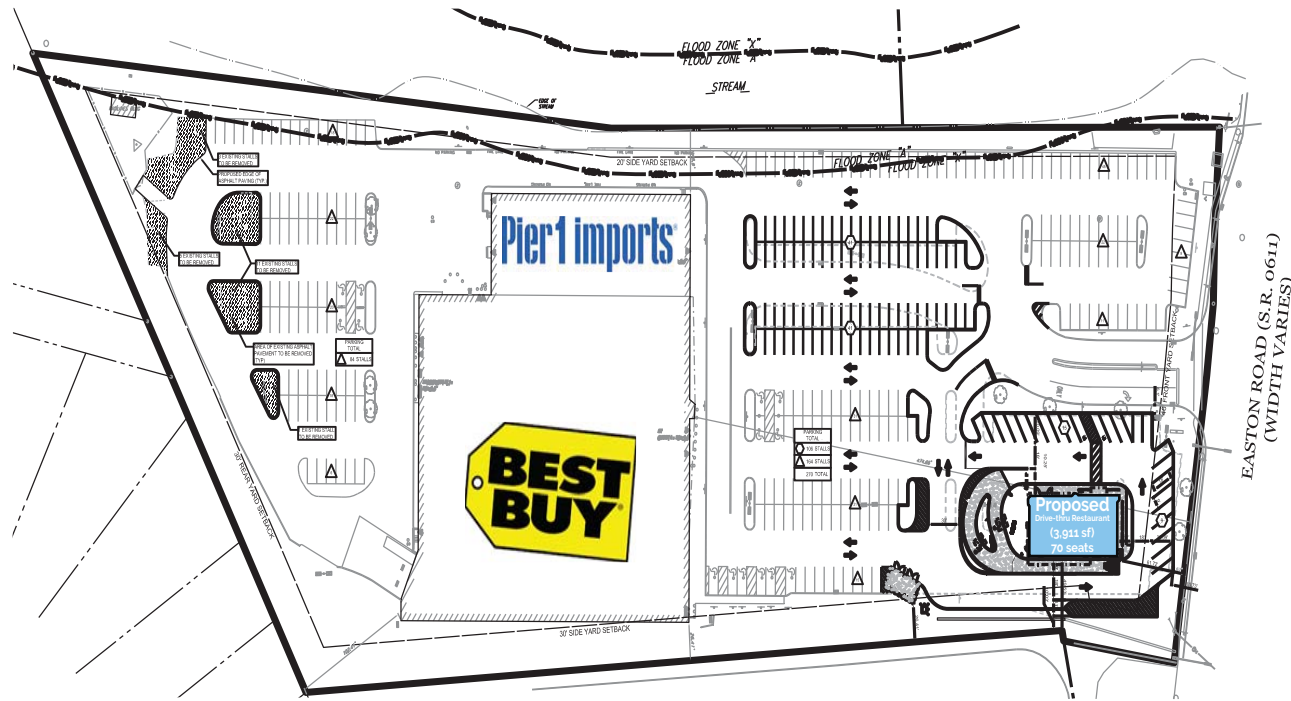

Option A: 3,911 s.f. approved pad site with double drive thru



Option B: 6,202 s.f. - Proposed multi-tenant retail building with no drive thru

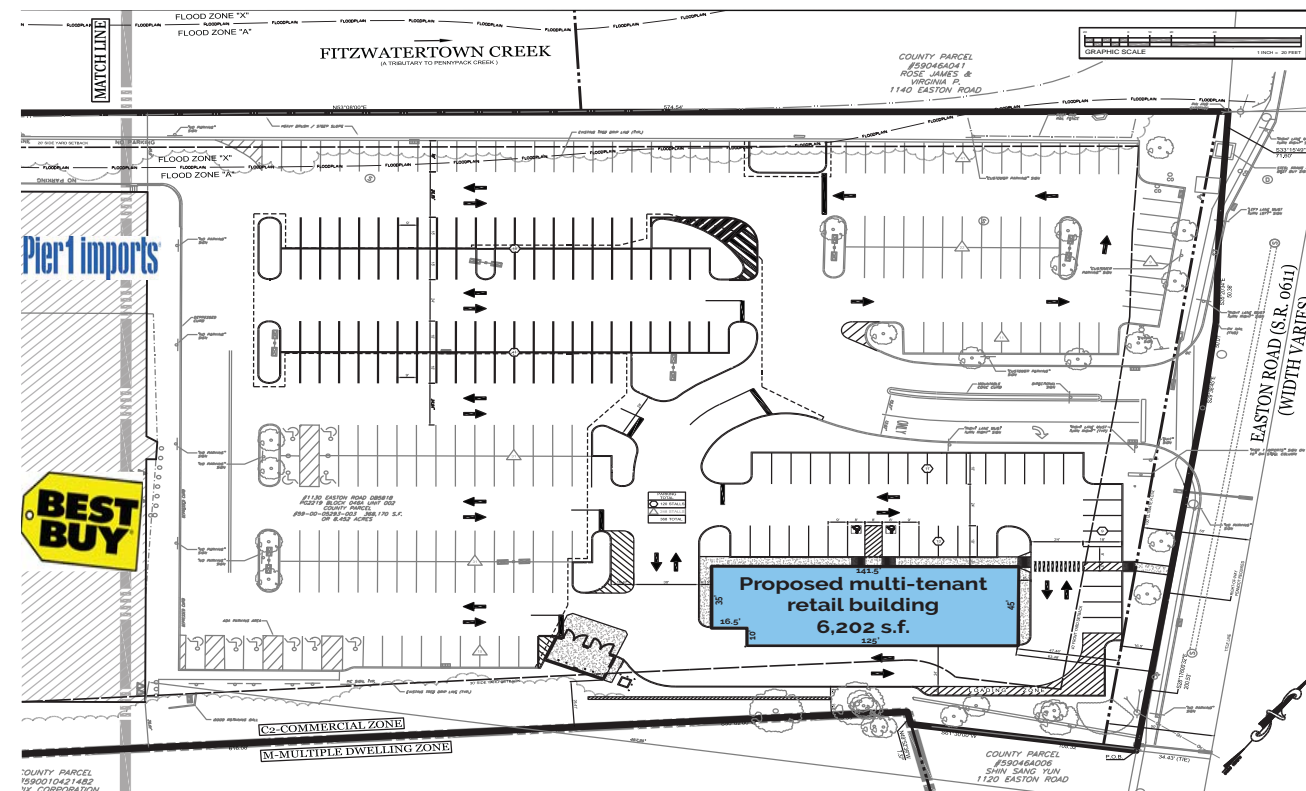

Approved Pad Site with double drive thru



Available: **Option A** - 3,911 s.f. approved pad site with double drive-thru. Perfect for bank or restaurant.

Option B - 6,202 s.f. - Proposed multi-tenant retail building with no drive thru.

Parking: Excellent on site parking. 270 parking spaces

Tenants: Join Best Buy & Pier 1 Imports

Demographics	1 mile	2 miles	3 miles	5 miles
Population	11,931	46,856	89,203	212,347
Households	5,126	19,107	35,433	84,687
Average HH Income	\$ 81,353	\$ 91,365	\$102,286	\$112,555
Median Age	40.2	40.2	40.5	43.2

